

# **HOBART**

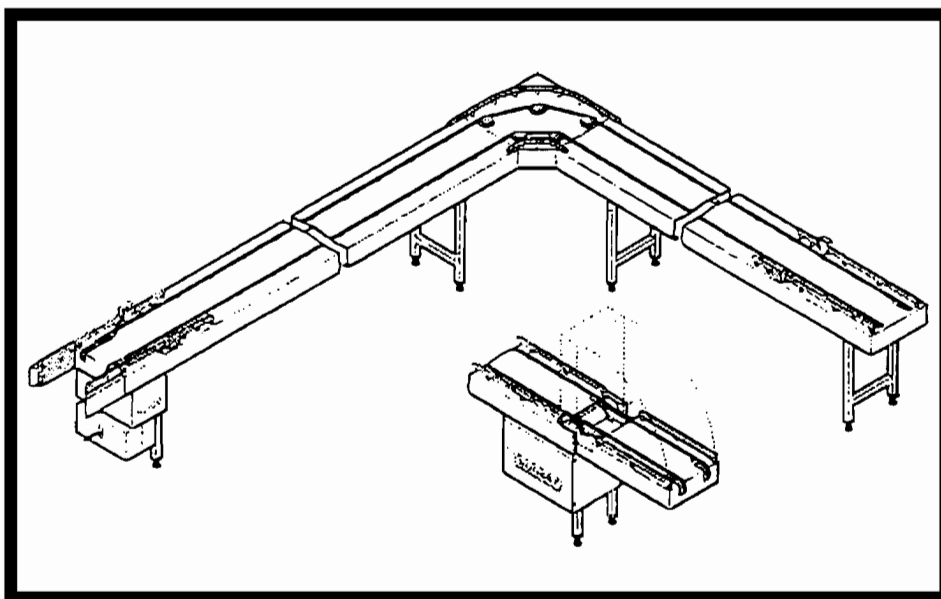

**POLYCORD - CONVEYOR  
CONVOYEUR A POLYCORDES  
RUNDRIEMENBAND  
KOORDENBAAN**

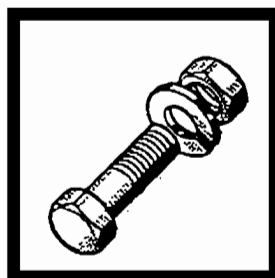

**Spare Parts  
Pièces Détachées  
Ersatzteile  
Onderdelen**

**VERSION 04/04/1997**

## Contents

Frame and feet .....	3
Shaft .....	4
Shaft with transmission .....	5
Transmission .....	6
Curve .....	7
Height limitation - tray inquiry station .....	8
Unloading device .....	9
Shaft with transmission inside .....	10
Loading device 1 .....	11
Loading device 2 .....	12
Interlock unit .....	13
Conveyor flap 1 .....	14
Conveyor flap 2 .....	15

## Inhalt

Korpus und Fußpaare.....	3
Umlenkwellen .....	4
Umlenkwellen mit Übertrieb.....	5
Antriebsstation .....	6
Kurvensegment .....	7
Höhenbegrenzung - Tablettabfrage .....	8
Abstapeleinrichtung .....	9
Umlenkwellen mit Übertrieb geschl. ....	10
Eintaktung 1 .....	11
Eintaktung 2 .....	12
Sperreinheit .....	13
Klappsegment 1 .....	14
Klappsegment 2.....	15

## Sommaire

Élément de convoyage droit avec pieds.....	3
Arbre.....	4
Arbre avec transmission .....	5
Transmission .....	6
Élément d'angle.....	7
Contrôle de hauteur - détection plateau .....	8
Unité d'empilage .....	9
Arbre de transmission final .....	10
Chargeur à plateaux pas à pas 1 .....	11
Chargeur à plateaux pas à pas 2 .....	12
Unité de blocage .....	13
Élément pivotant 1 .....	14
Élément pivotant 2.....	15

## Inhoud

Frame en Pootstellen .....	3
Keer-as .....	4
Keer-as een aandrijving.....	5
Aandrijf unit.....	6
Hoek unit .....	7
Hoogte uitlezing Dienplaten .....	8
Ortladings unit .....	9
Gesloten keer-as met aandrijving .....	10
Ladings unit 1 .....	11
Ladings unit 2 .....	12
Blokkeer inrichting .....	13
Deksel segment 1 .....	14
Deksel segment 2.....	15

Please order polycords and tray guides by giving part-N° and length.  
A la commande des polycordes et guides plateaux, indiquez N° de pièce et longueur.  
Rundriemen und Tablettführungen nach Teile-N° mit Längenangabe bestellen.  
Bij bestelling van de koorden of de dienbladengeleiders graag het artikel nummer en de lengte opgeven.

Version 02.95

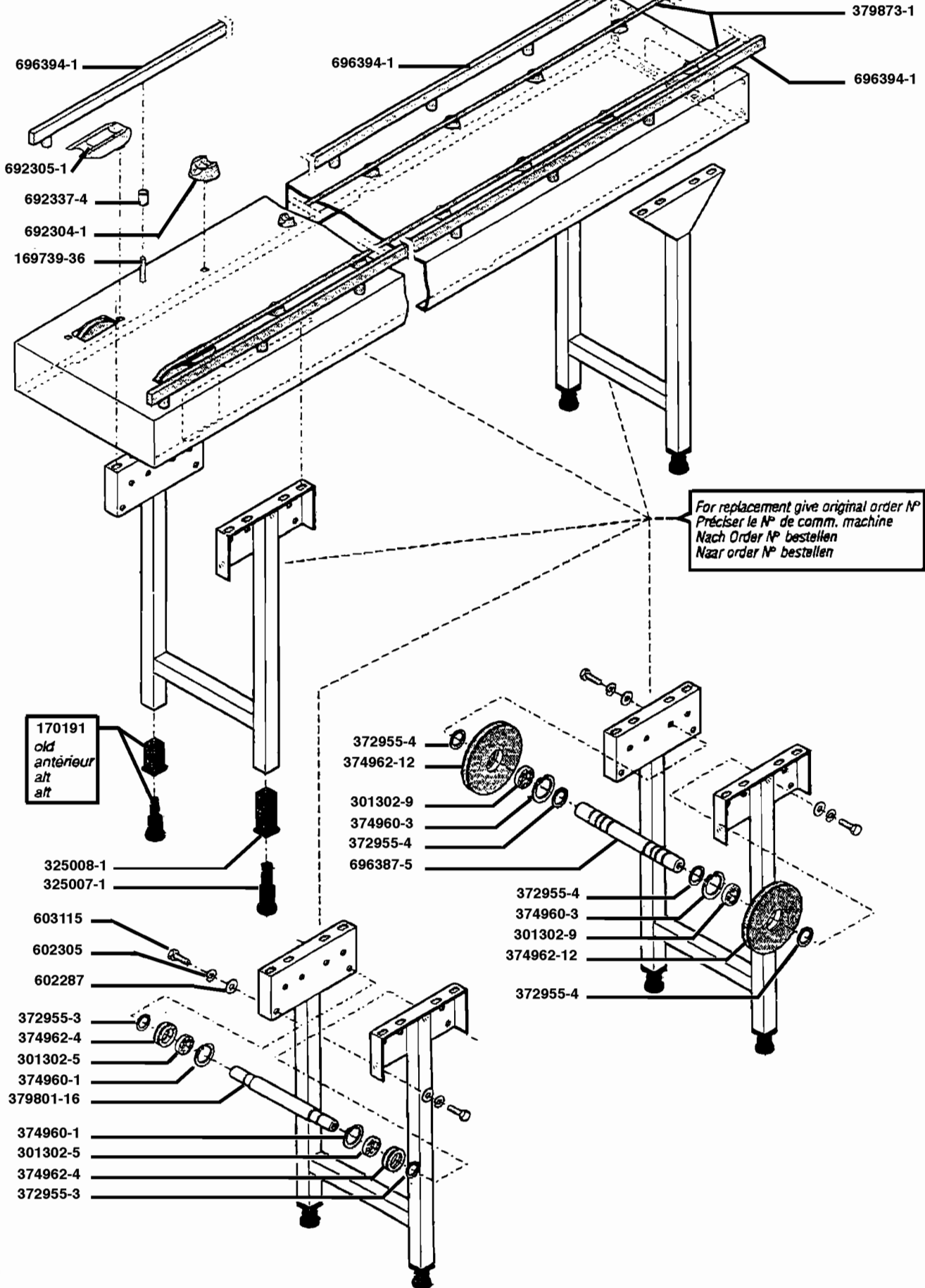

380291-5

Version 08.94

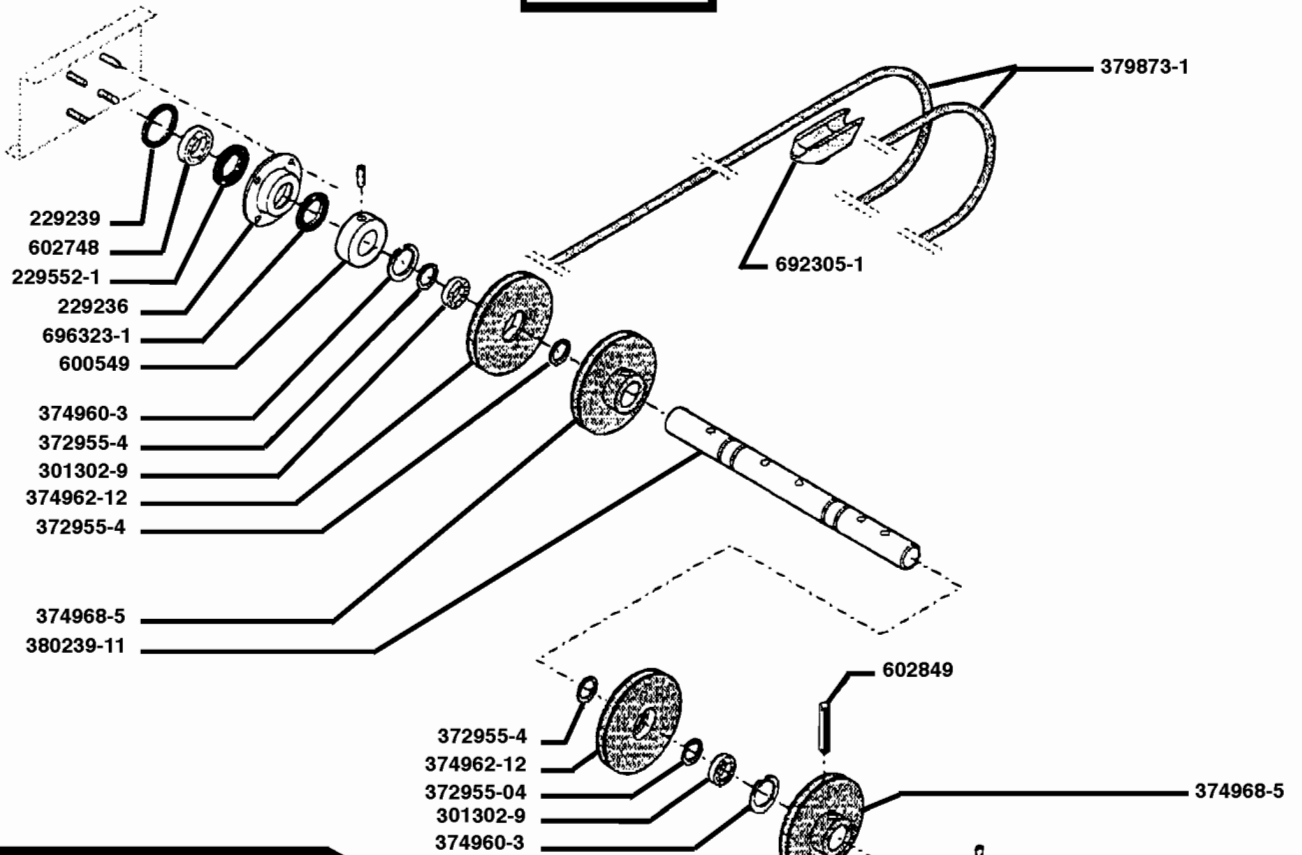

380604-4

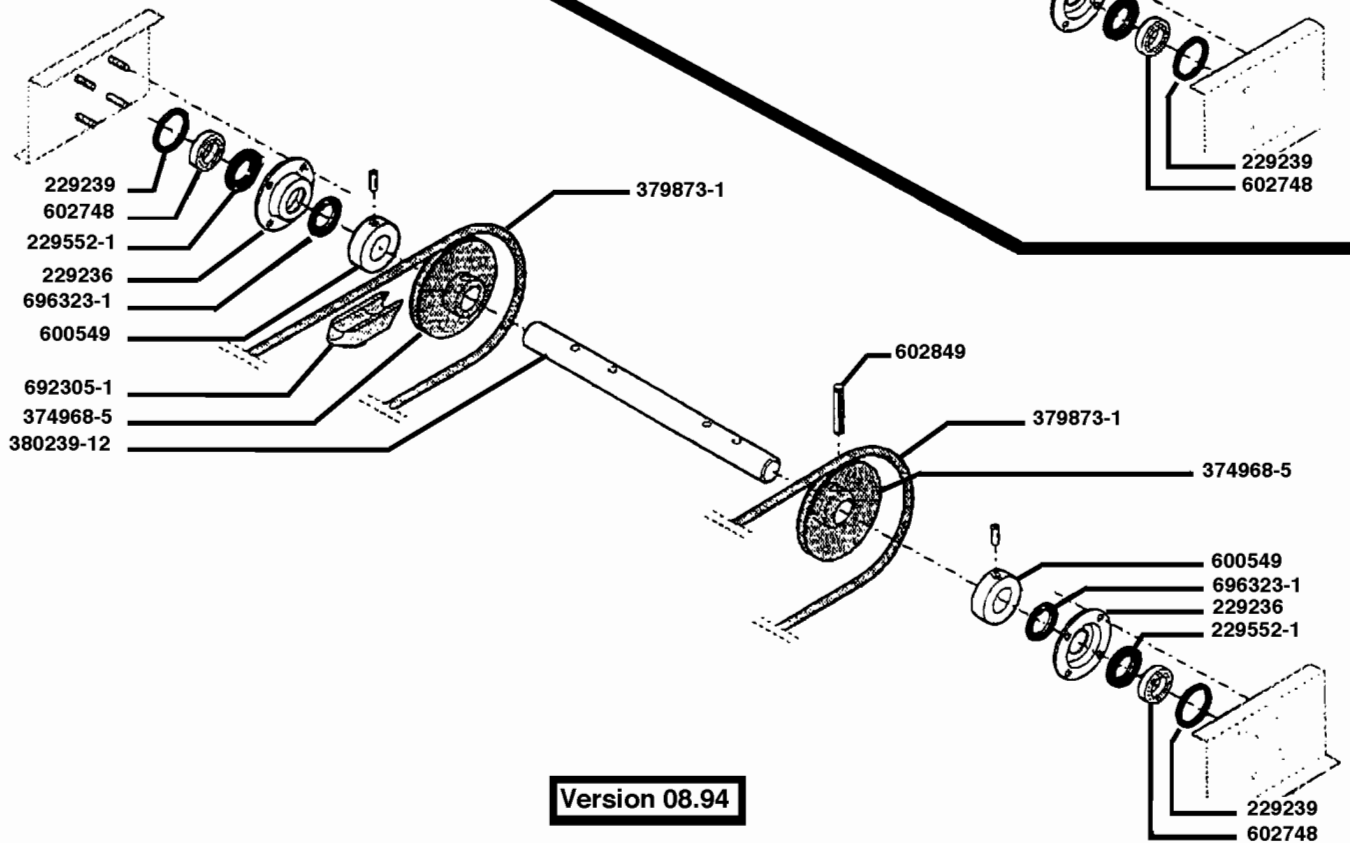

Version 08.94

Version 08.94

380291-5

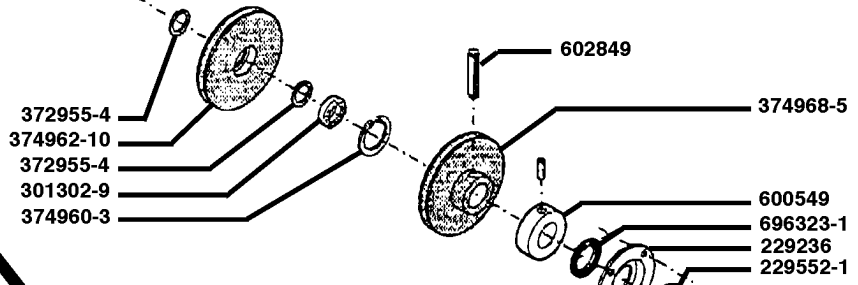
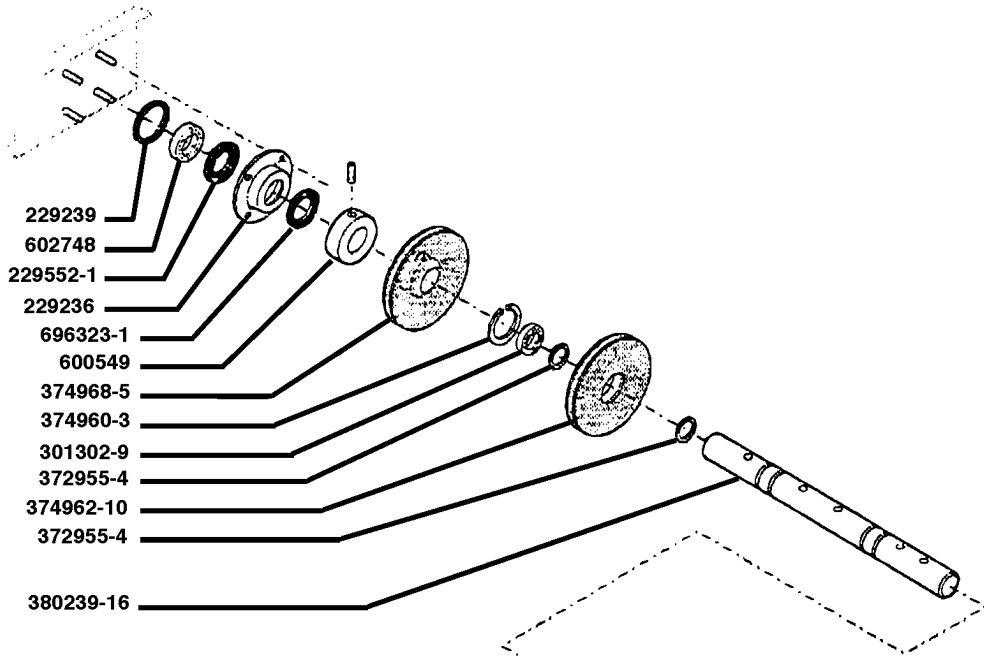

380233-5

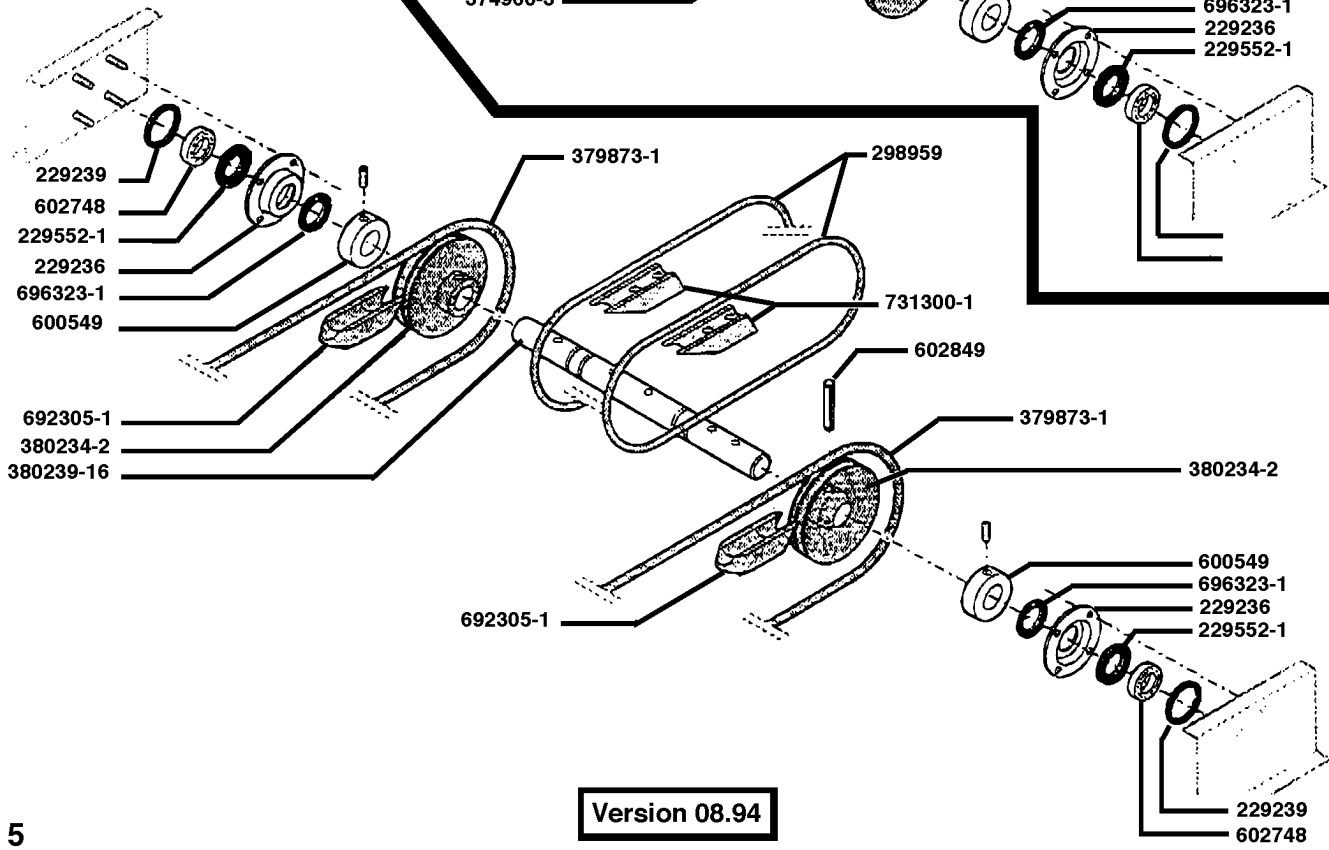

Version 08.94

Version 11.95

692061-11

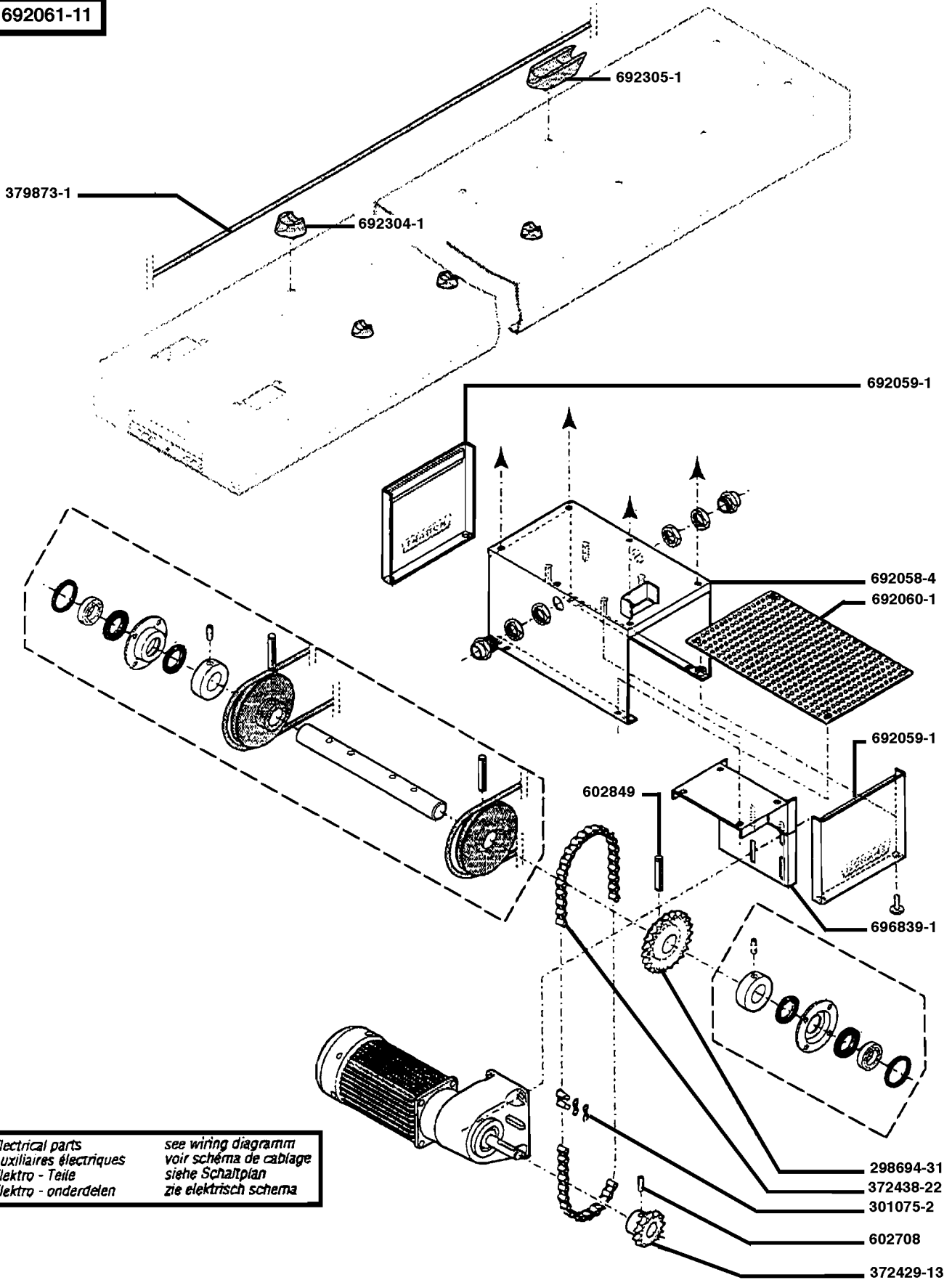

Electrical parts	see wiring diagram
Auxiliaires électriques	voir schéma de câblage
Elektro - Teile	siehe Schaltplan
Elektro - onderdelen	zie elektrisch schema

Version 09.93

692389-90  
692389-89

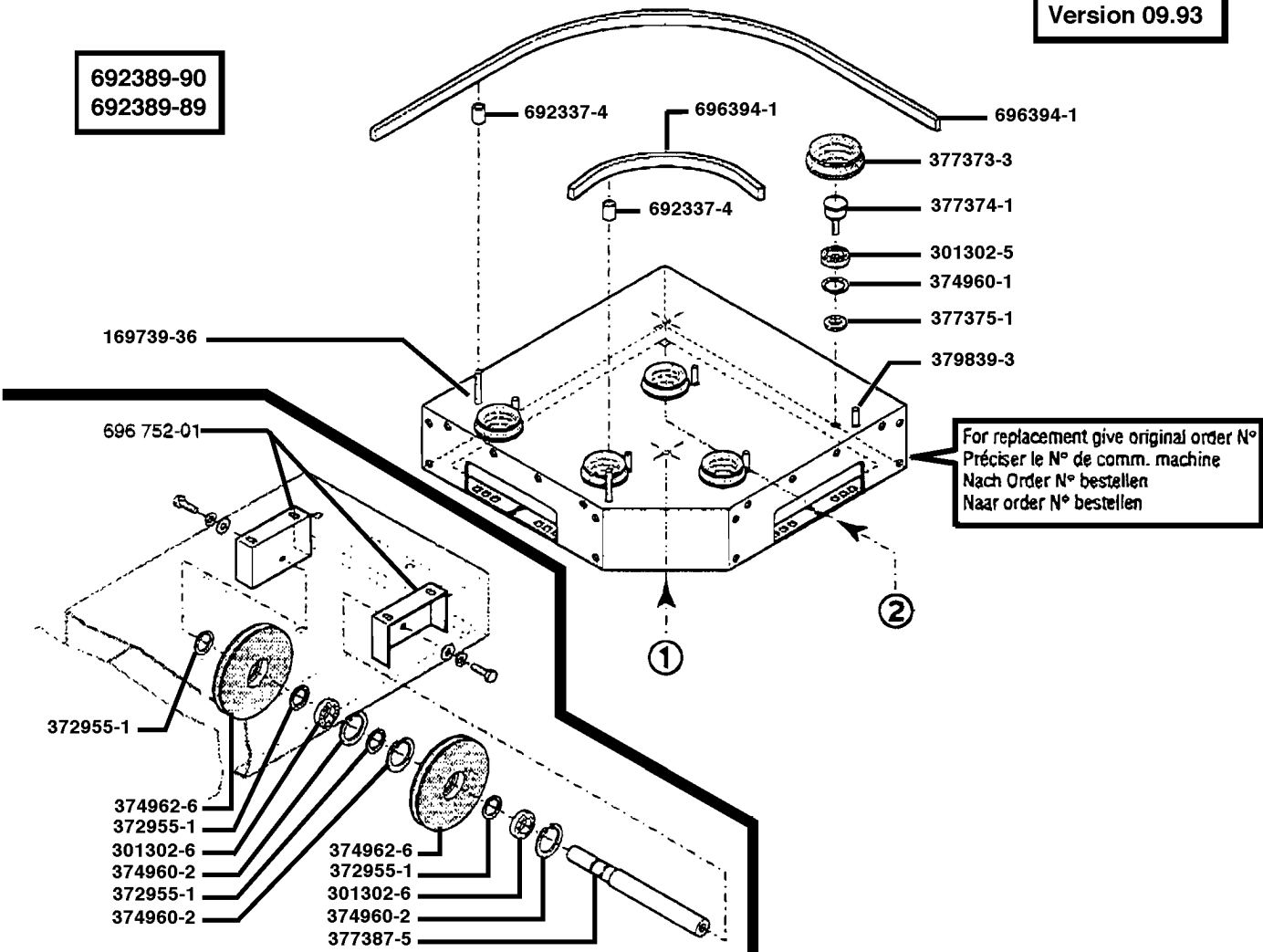

692389-90

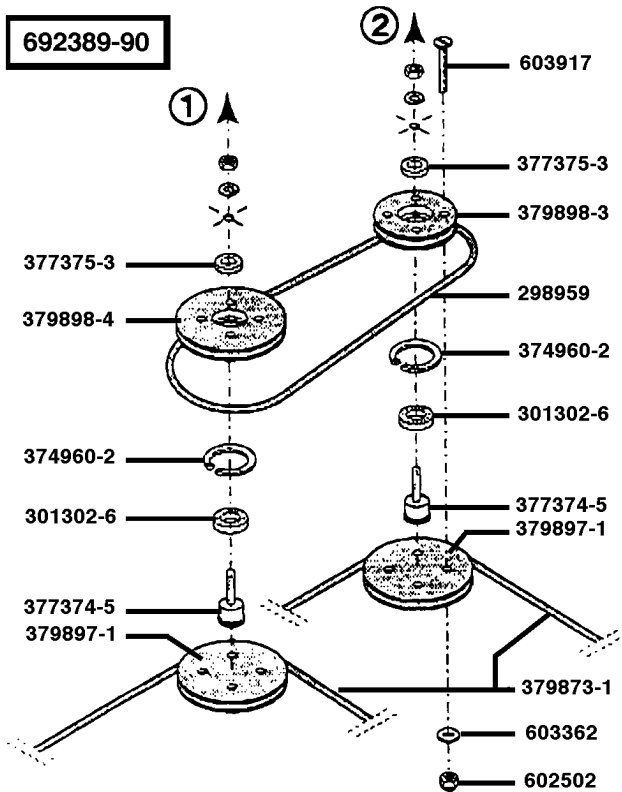

692389-89

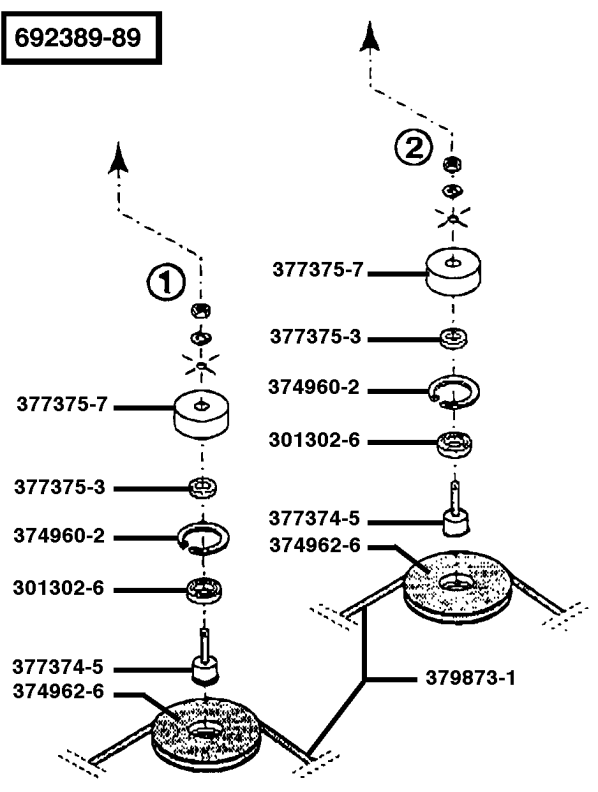

Version 11.95

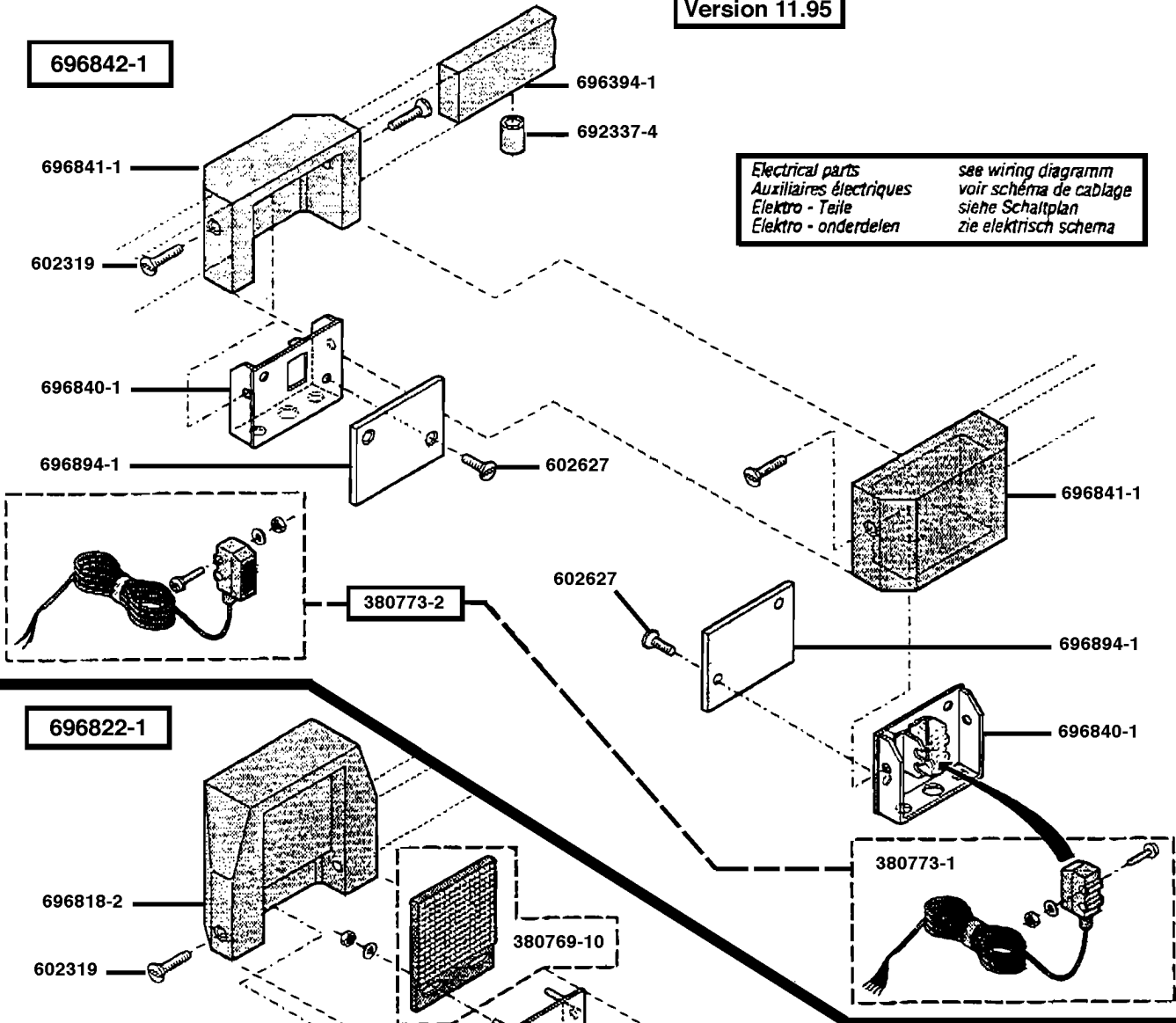

Electrical parts  
Auxiliaires électriques  
Elektro - Teile  
Elektro - onderdelen

see wiring diagram  
voir schéma de cablage  
siehe Schaltplan  
zie elektrisch schema

Version 06.95

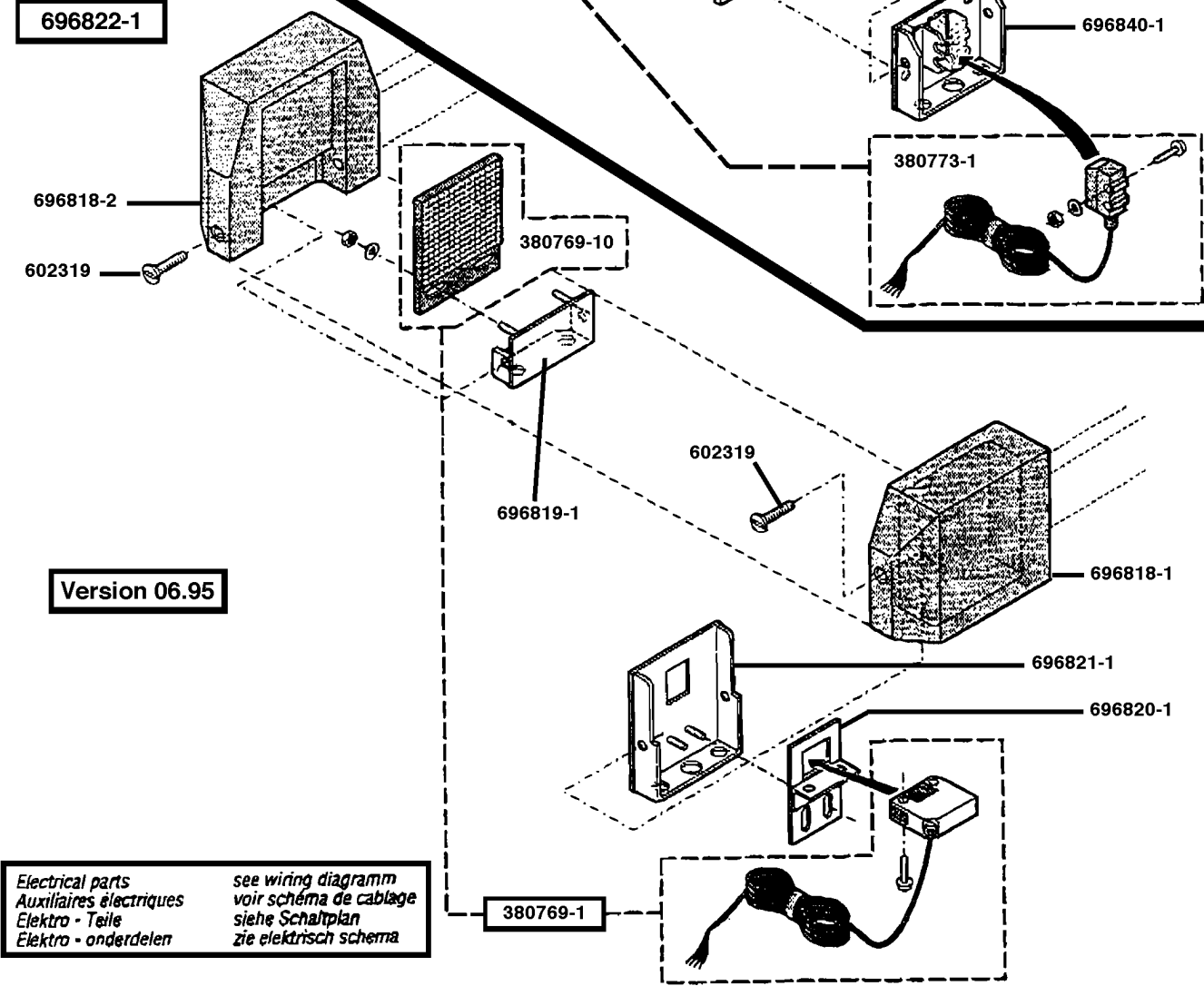

Electrical parts  
Auxiliaires électriques  
Elektro - Teile  
Elektro - onderdelen

see wiring diagram  
voir schéma de cablage  
siehe Schaltplan  
zie elektrisch schema



Version 03.95

692932-1

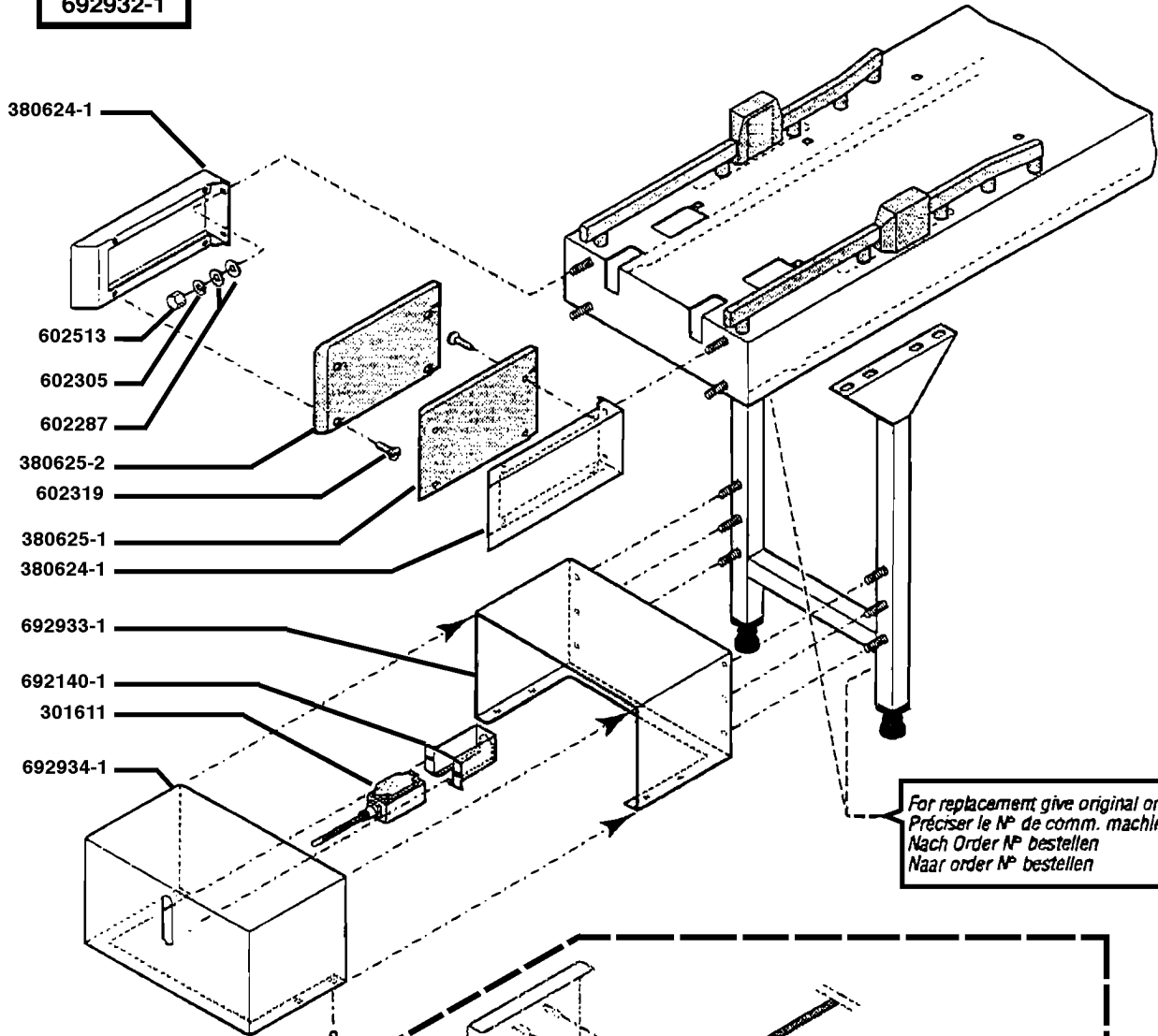

For replacement give original order N°  
Préciser le N° de comm. machine  
Nach Order N° bestellen  
Naar order N° bestellen

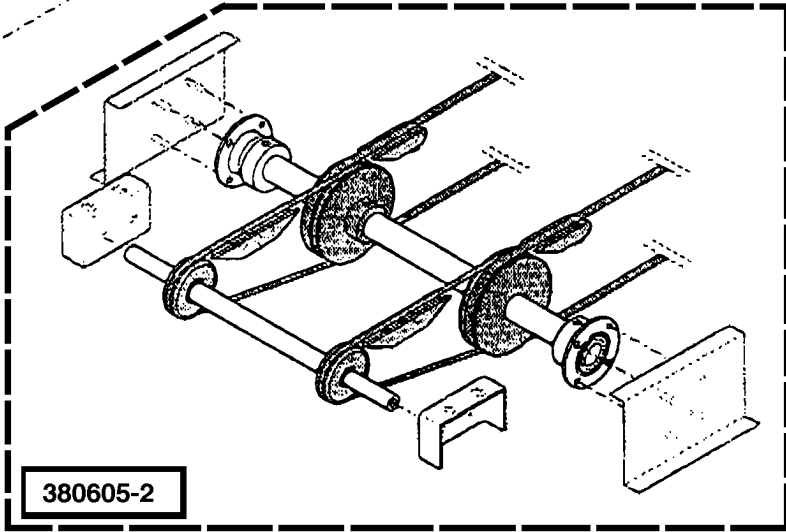

380605-2

Electrical parts	see wiring diagram
Auxiliaires électriques	voir schéma de câblage
Elektro - Teile	siehe Schaltplan
Elektro - onderdelen	zie elektrisch schema

Version 10.94

380605-2

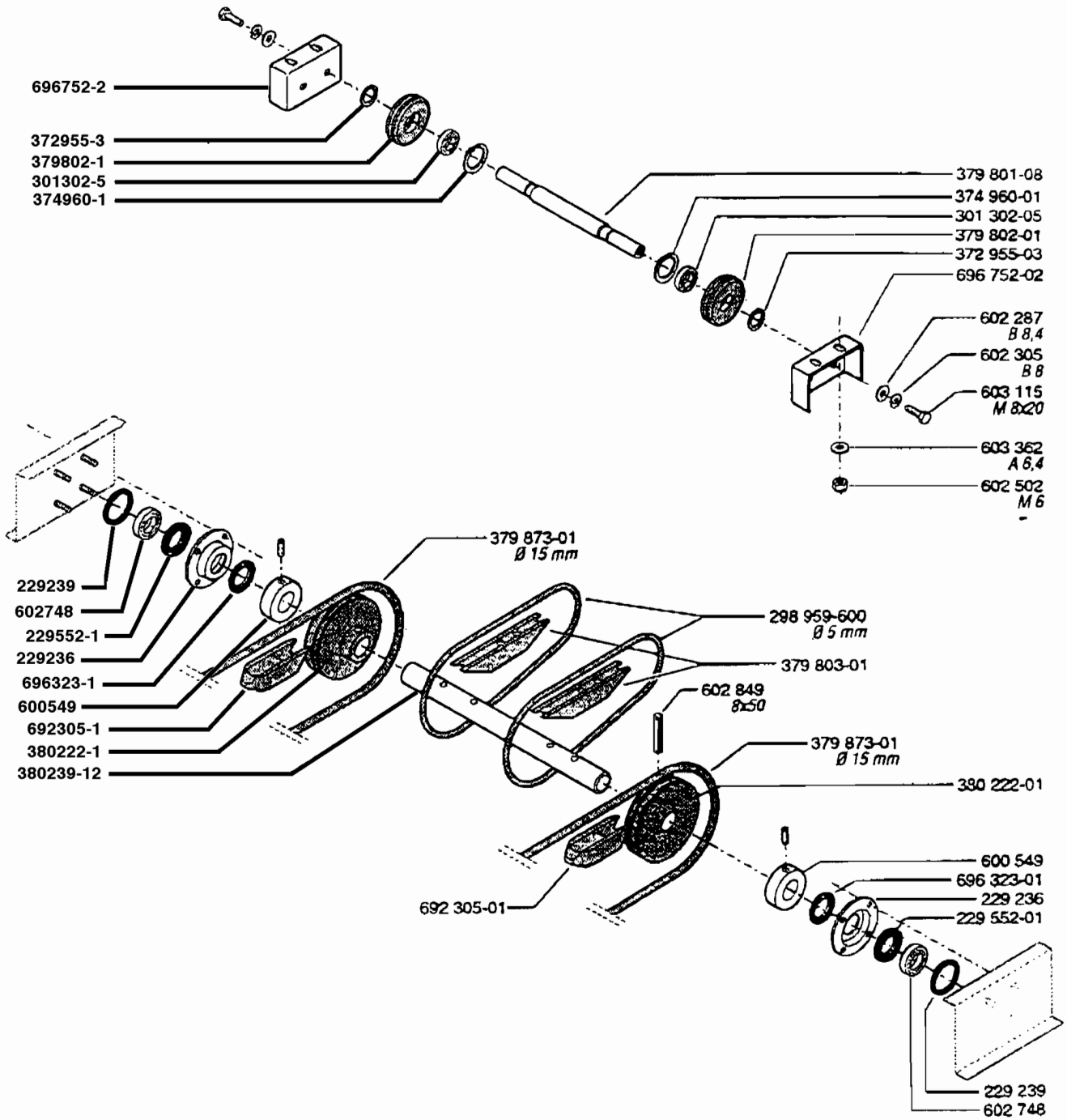

Version 10.94

696320-6

Electrical parts  
Auxiliaires électriques  
Elektro - Teile  
Elektro - onderdelen

see wiring diagram  
voir schéma de cablage  
siehe Schaltplan  
zie elektrisch schema

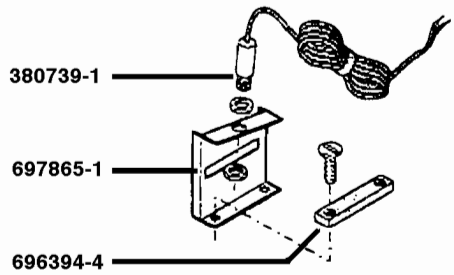

For replacement give original order N°  
Préciser le N° de comm. machine  
Nach Order N° bestellen  
Naar order N° bestellen

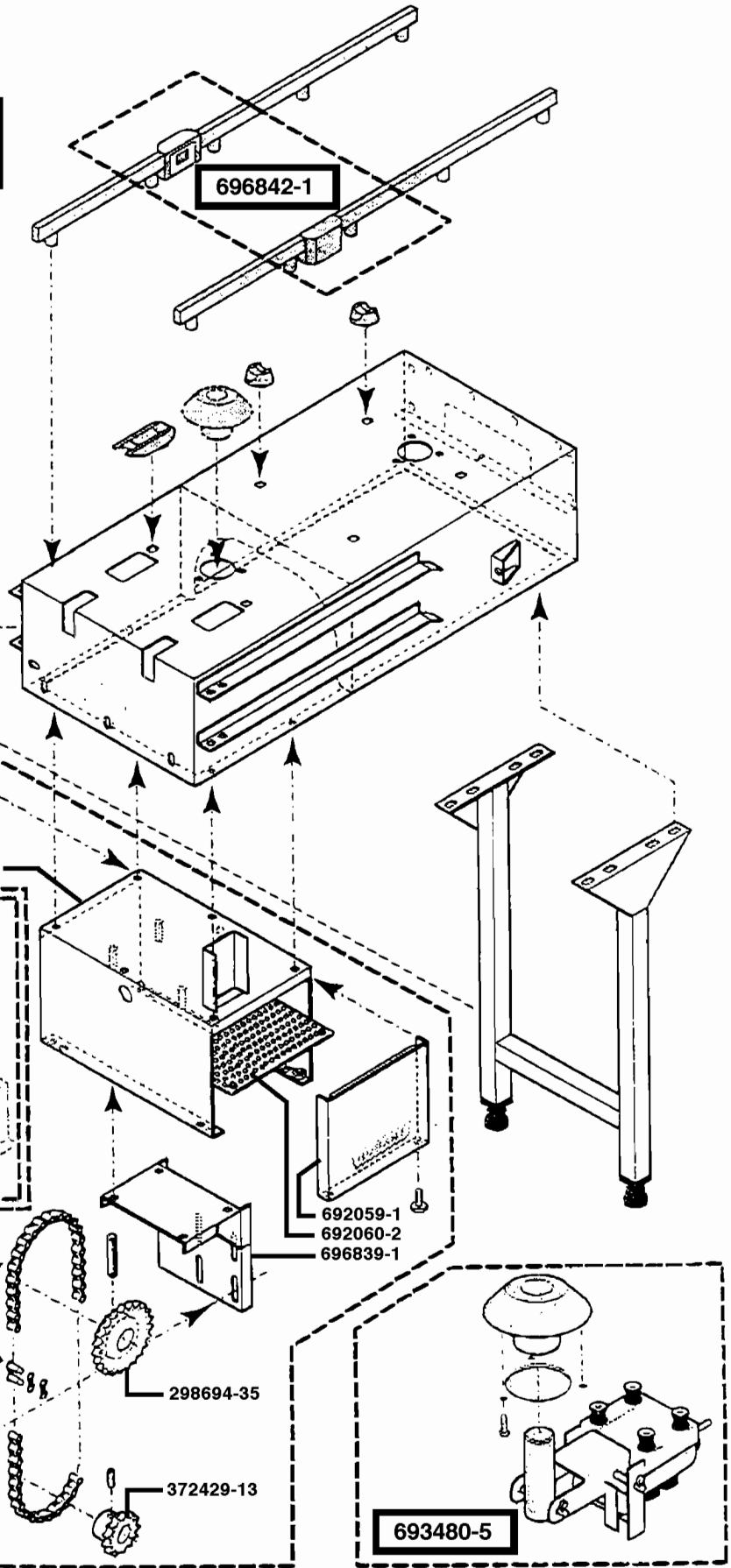

Version 10.94

693499-3

Electrical parts  
Auxiliaires électriques  
Elektro - Teile  
Elektro - onderdelen

see wiring diagram  
voir schéma de cablage  
siehe Schaltplan  
zie elektrisch schema

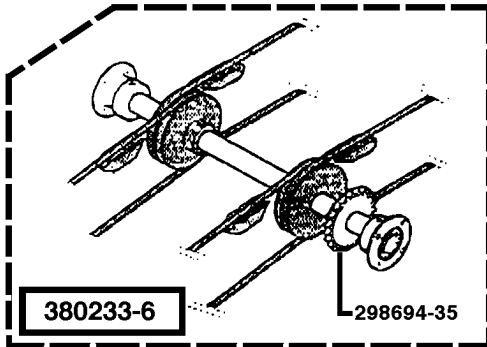

For replacement give original order N°  
Préciser le N° de comm. machine  
Nach Order N° bestellen  
Naar order N° bestellen

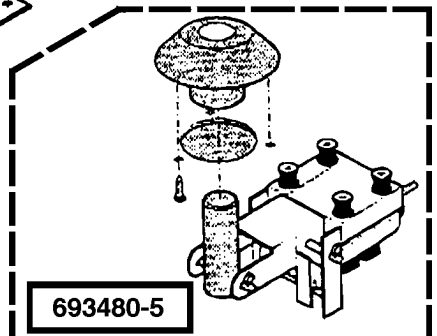
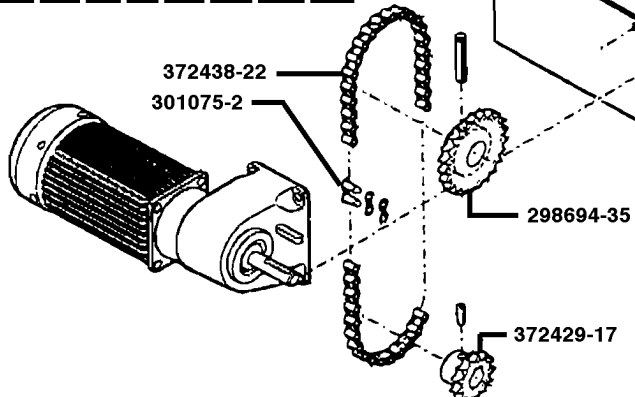
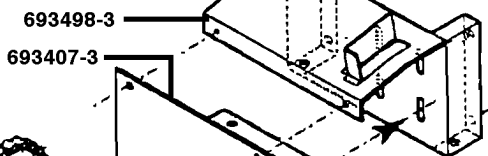
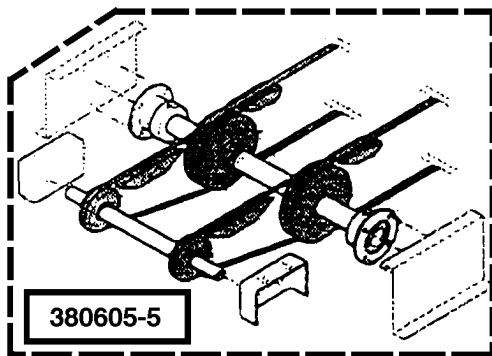
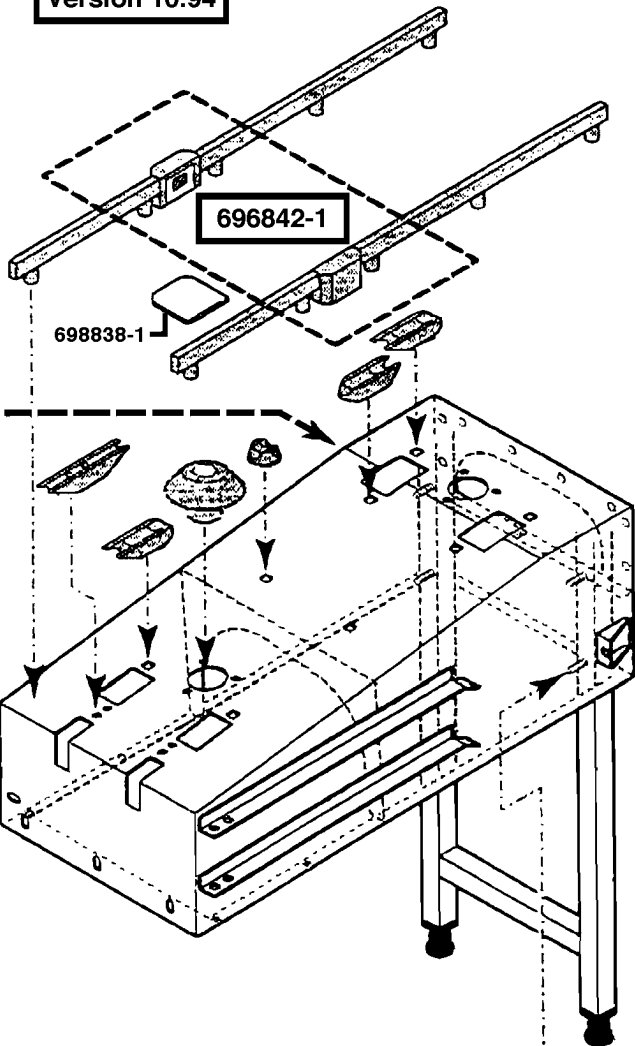
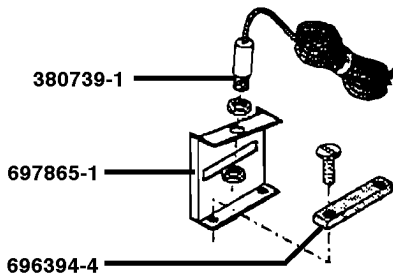

Version 08.95

693480-5

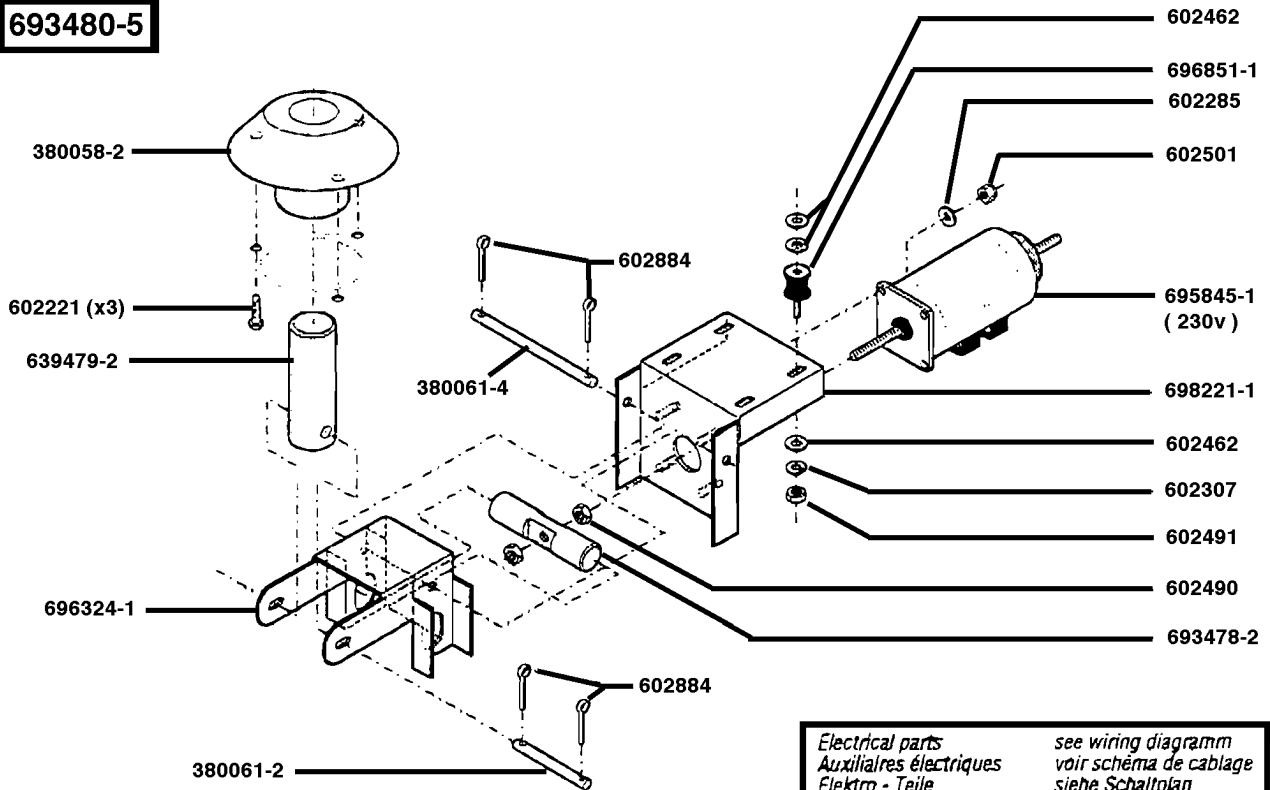

Electrical parts	see wiring diagram
Auxiliaires électriques	voir schéma de cablage
Elektro - Teile	siehe Schaltplan
Elektro - onderdelen	zie elektrisch schema

Version 12.96

692971-4

For replacement give original order N°  
Préciser le N° de comm. machine  
Nach Order N° bestellen  
Naar order N° bestellen

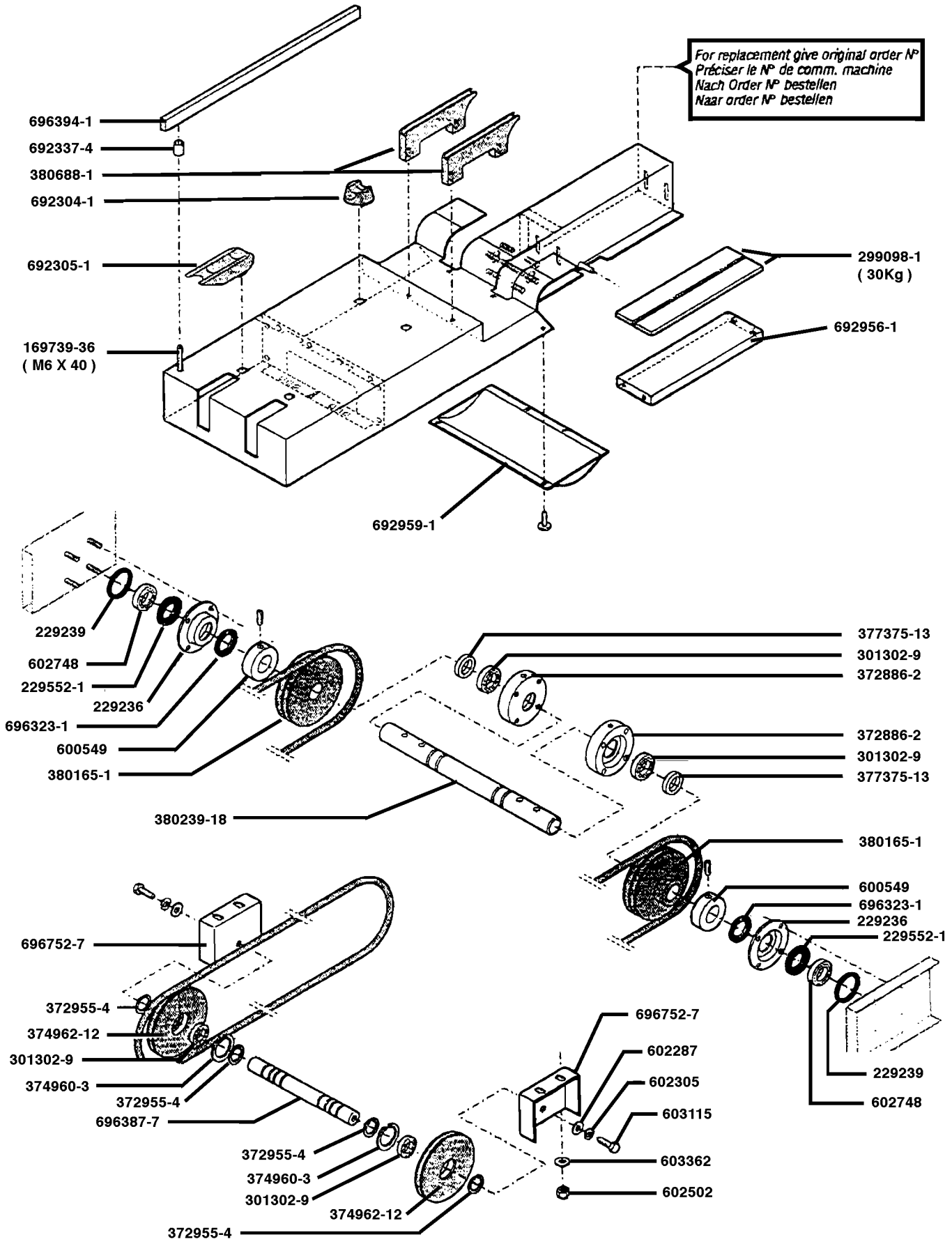

Version 12.96

